



ROHS-Compliant Product

Selectionfilter



Examples of our product range > 21.4 MHz < 100 MHz

Type	Frequency	Case Style	Passband		Stopband		Termination in/out	POLE	Insertion loss max.
	MHz		dB	± kHz	dB	± kHz	(Ω)		dB
XF-214S73-LF	21,425	BF10-13.0	3	15	60	55	50	6	4,5
XF-214S30-LF	21,48	BF10-15.9	3	20	80	75	910 // 15 pF	6	3,5
XF-215S04-LF	21,50	BF10-13.0	3	15	60	55	50	6	4,5
XF-215S03-LF	21,50	BF10-13.0	6	25	60	50	50	8	3
XF-215S01-LF	21,52	BF10-15.9	3	20	80	75	910 // 15 pF	6	3,5
XF-249S01-LF	24,968	BF01	3	25	60	50	910 // 15 pF	8	2
XF-249S02-LF	24,988	BF10-13.0	3	5	60	12,5	910 // 15 pF	8	4
XF-250S05-LF	25,00	BF10-13.0	3	2	60	18	50	4	4
XF-250S03-LF	25,00	BF01	3	15	60	30	1000 // 25 pF	8	3
XF-299S02-LF	29,998	BF30	3	60	10	150	50	2	3,5
XF-300S11-LF	30,00	BF10-13.0	3	6	40	33	50	4	4
XF-300S03-LF	30,00	BF10-13.0	3	7,5	40	22	50	4	2
XF-300S02-LF	30,00	BF01	0,4	14	10	45	1300 // 15 pF	4	3
XF-300S09-LF	30,00	BF01	3	30	60	60	50	8	4
XF-343S01-LF	34,3625	BF10-13.0A	3	7,5	70	17	50	8	5
XF-354S03-LF	35,40	BF10-13.0	3	4,25	60	20	50	6	4,5
XF-400S01-LF	40,00	BF10-13.0	3	7,5	50	30	50	4	6
XF-400S11-LF	40,00	BF33	3	17	60	150	50	4	5
XF-422S03-LF	42,20	BF10-13.0	6	0,35	60	2	50	8	15
XF-450S03-LF	45,00	BF10-13.0	3	7,5	60	19	50	8	8
XF-500S01-LF	50,00	BF01	3	6	60	20	50	6	5
XF-527S01-LF	52,70	BF41	3	4	60	13	50	6	6
XF-700S37-LF	70,00	BF68-12.5	3	12,5	40	75	50	4	5
XF-709S01-LF	70,9379	BF10-15.9	1	0,75	30	7,5	25	4	10
XF-747S01-LF	74,775	BF10-13.0	3	7,5	40	27	50	4	5
XF-750S02-LF	75,00	BF10-13.0	3	4,5	60	20	50	6	6
XF-750S01-LF	75,00	BF01	3	7	40	14	75	8	5
XF-800S05-LF	80,00	BF13	3	6	25	2500	500 // 30 pF	2	4
XF-814S01-LF	81,40	BF41	1	6	60	50	50	4	4
XF-842S01-LF	84,295	BF10-13.0	3	6,5	40	35	50	4	6
XF-980S02-LF	98,00	BF195-11.0	2	15	25	50	50	6	6

KVG Quartz Crystal Technology GMBH

D-74922 Neckarbischofsheim P.O.B. 61 74924 Neckarbischofsheim Waibstadter Strasse 2 - 4
 Tel: +49 (0) 7263 / 648 - 0 Fax: +49 (0) 7263 / 6196 e-mail:info@kvg-gmbh.de



ROHS-Compliant Product

Selectionfilter



Case Style BF01

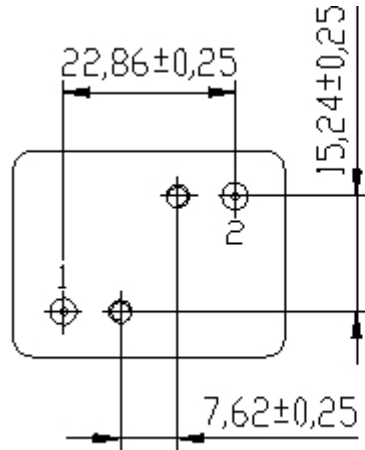

DIN IEC 49(CO)20E
Typ F01

1 = IN
2 = OUT

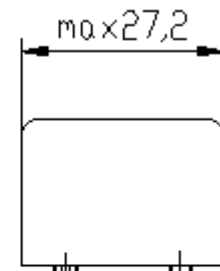
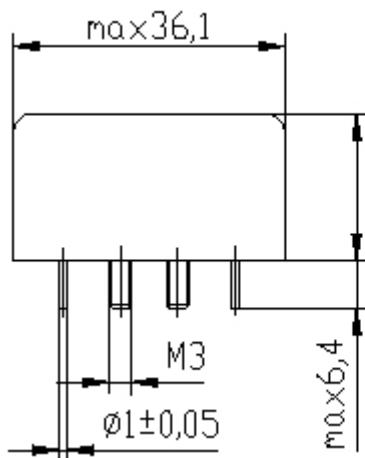

Height: BF01 max 19.4mm

KVG Quartz Crystal Technology GMBH

D-74922 Neckarbischofsheim P.O.B. 61 74924 Neckarbischofsheim Waibstadter Strasse 2 - 4
Tel: +49 (0) 7263 / 648 - 0 Fax: +49 (0) 7263 / 6196 e-mail: info@kvg-gmbh.de

Selectionfilter

Case Style BF10-13.0; BF10-15.9

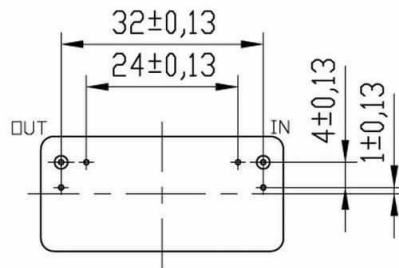

DIN IEC 49(CO)208
Typ F02

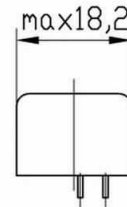
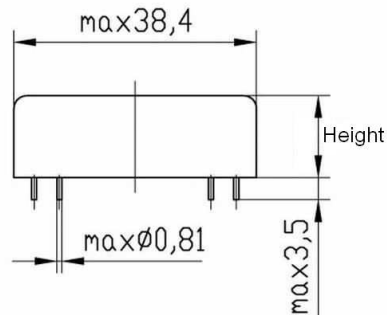

Height: BF10-13.0 = 13.0 mm
BF10-15.9 = 15.9 mm

Case Style BF10-13.0A

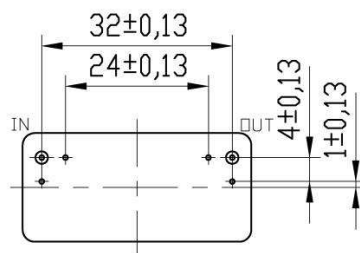

DIN IEC 49(CO)208
Typ F02

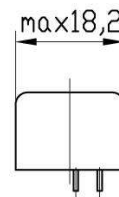
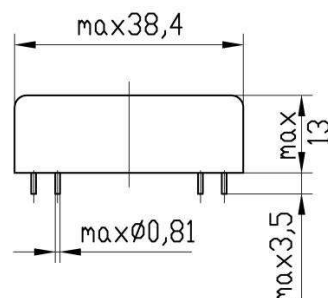



ROHS-Compliant Product

Selectionfilter



Case Style BF13

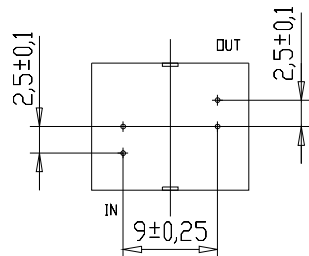

DIN IEC 49(CO)208
Typ F04

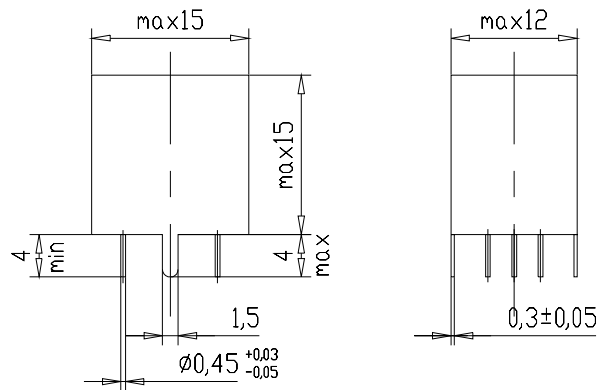

Case Style BF30

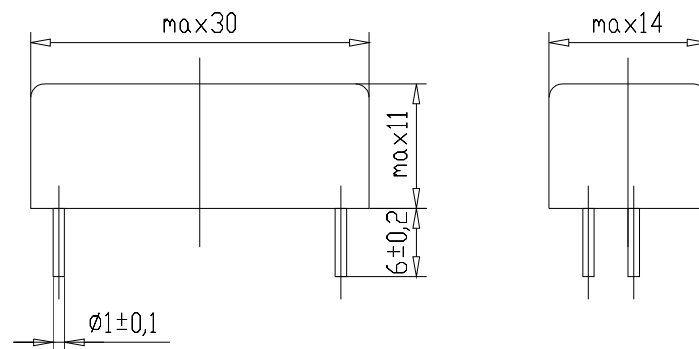
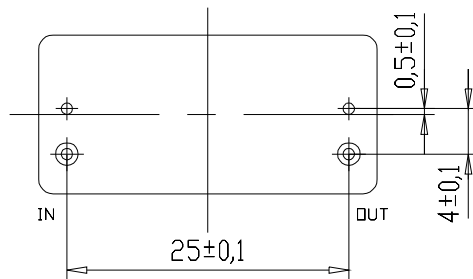

KVG Quartz Crystal Technology GMBH

D-74922 Neckarbischofsheim P.O.B. 61 74924 Neckarbischofsheim Waibstadter Strasse 2 - 4
Tel: +49 (0) 7263 / 648 - 0 Fax: +49 (0) 7263 / 6196 e-mail: info@kvg-gmbh.de

Selectionfilter

Case Style BF33

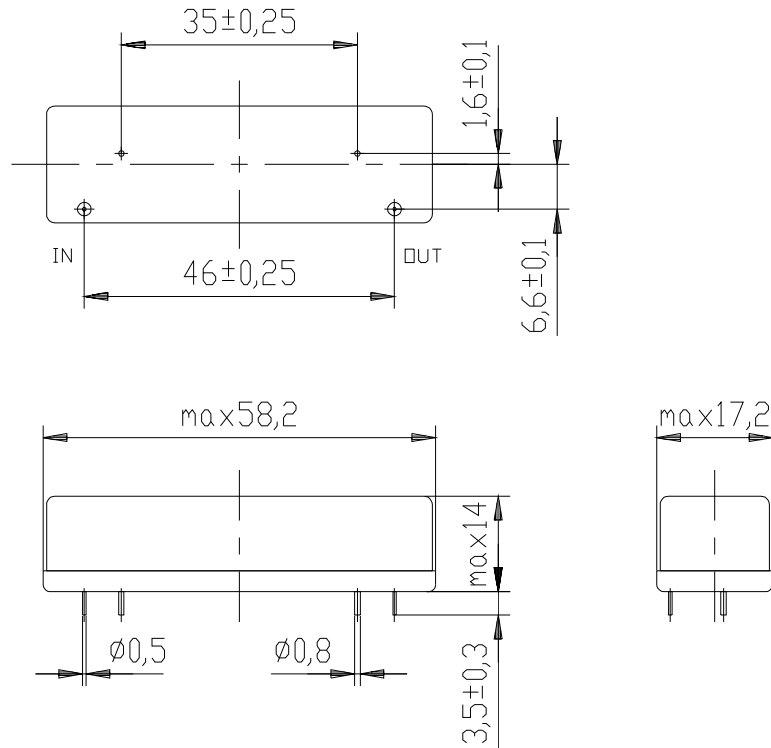

Case Style BF41

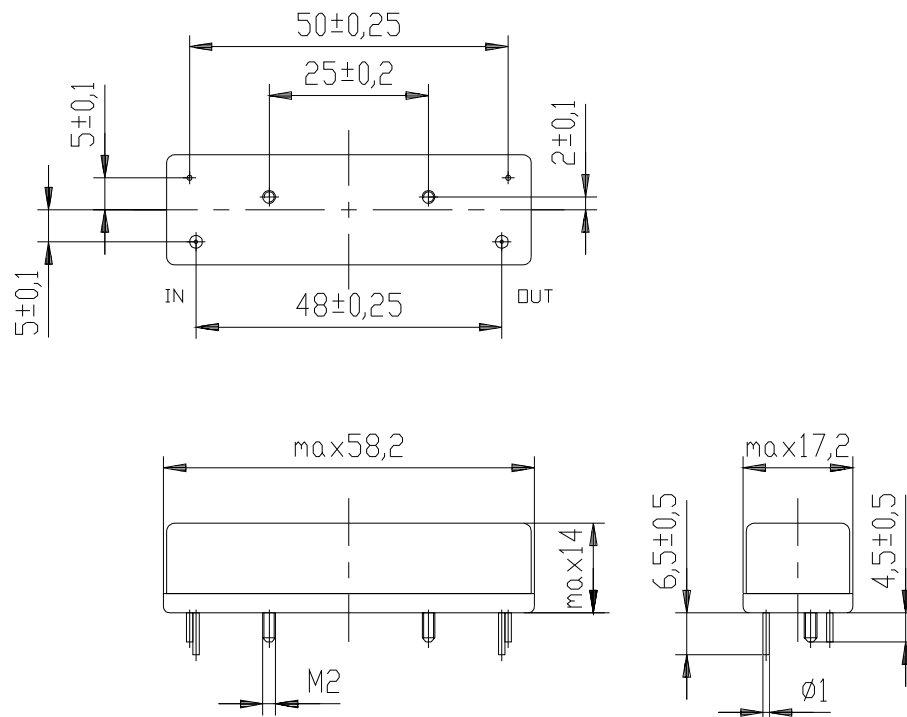

Case Style BF68-12.5

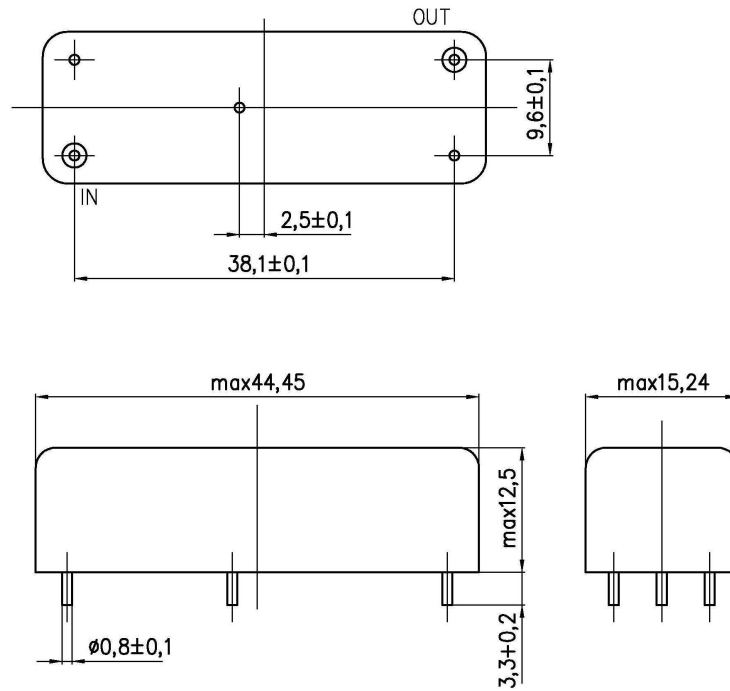

Case Style BF195-11.0

