



ROHS-Compliant Product

Linear phase filter



Examples of our product range ≤ 10.70 MHz

Type	Frequency	Case Style	Passband		Stopband		Termination in/out	POLE	Insertion loss max.
	MHz		dB	± kHz	dB	± kHz	(Ω)		dB
XF-25S03-LF	2,50	BF01	3	3	60	7	50	8	8
XF-50S18-LF	5,00	BF01	3	2	30	10	3500 // 25 pF	4	4
XF-50S20-LF	5,00	BF01	3	4	30	17	50	4	4
XF-50S23-LF	5,00	BF01	3	4	30	17	500	4	4
XF-50S19-LF	5,00	BF01	3	4	30	17	3500 // 25 pF	4	4
XF-64S01-LF	6,40	BF01	3	1,2	66	10	1000 // 25 pF	4	2
XF-64S03-LF	6,40	BF01	3	8	25	30	75	4	10
XF-79S05-LF	7,90	BF02	3	0,12	60	1,2	500 // 25 pF	4	9
XF-79S02-LF	7,90	BF02	3	0,4	60	4,5	50 // 25 pF	4	6
XF-79S03-LF	7,90	BF02	3	1,2	60	14	50 // 25 pF	4	6
XF-79S04-LF	7,90	BF02	3	4	60	50	500 // 25 pF	4	6
XF-87S01-LF	8,7256	BF10-13.0	3	10	60	80	50	6	8
XF-89S09-LF	8,99815	BF01	3	1,55	60	2,55	1000 // 25 pF	8	2,5
XF-89S22-LF	8,9985	BF01	3	1,23	50	2,4	300 // 30 pF	8	3,5
XF-90S90-LF	9,00	BF01	3	1,9	60	9	500 // 30 pF	8	5
XF-90S84-LF	9,0124	BF02	6	0,25	30	0,75	500 // 30 pF	4	5
XF-100S21-LF	10,00	BF01	3	0,25	60	3	500 // 25 pF	4	5
XF-100-5-LF	10,00	BF01	3	2,25	60	20	50	4	10
XF-100S16-LF	10,00	BF01	3	2,5	60	25	50	4	3
XF-100S23-LF	10,00	BF02	3	3,25	40	25	50	4	2,5
XF-100S22-LF	10,00	BF02	3	20	40	125	50	4	4
XF-100S31-LF	10,034	BF01	3	2,5	60	25	50 // 25 pF	4	2
XF-107S33-LF	10,70	BF02	3	1,25	60	12	400 // 25 pF	4	3
XF-107S103-LF	10,70	BF01	3	3	60	24	50	4	3
XF-107S25-LF	10,70	BF01	3	3	80	7	820 // 25 pF	8	3,5
XF-107S274-LF	10,70	BF10-13.0	3	77,5	90	500	50	6	9

KVG Quartz Crystal Technology GMBH

D-74922 Neckarbischofsheim P.O.B. 61 74924 Neckarbischofsheim Waibstadter Strasse 2 - 4
 Tel: +49 (0) 7263 / 648 - 0 Fax: +49 (0) 7263 / 6196 e-mail:info@kvg-gmbh.de



ROHS-Compliant Product

Linear phase filter



Case Style BF01

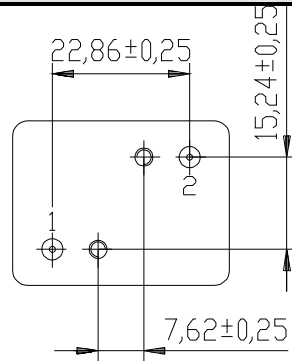

DIN IEC 49(CO)208
Typ F01

1 = IN
2 = OUT

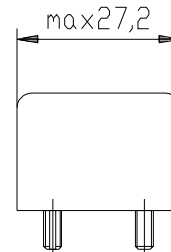
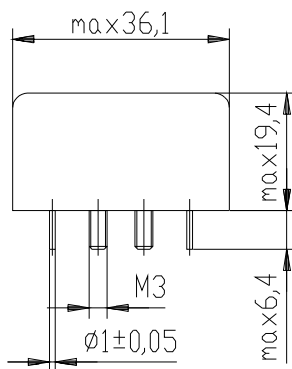

Case Style BF02

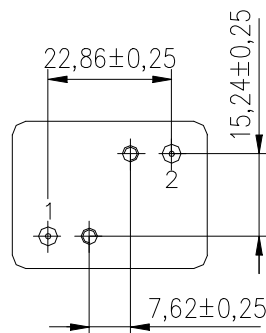

1 = IN
2 = OUT

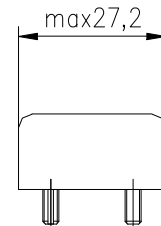
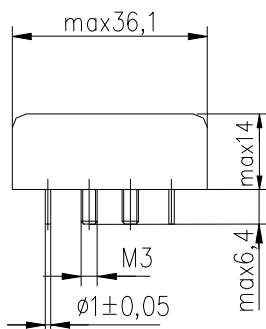

KVG Quartz Crystal Technology GMBH

D-74922 Neckarbischofsheim P.O.B. 61 74924 Neckarbischofsheim Waibstadter Strasse 2 - 4
Tel: +49 (0) 7263 / 648 - 0 Fax: +49 (0) 7263 / 6196 e-mail: info@kvg-gmbh.de



ROHS-Compliant Product

Linear phase filter



Case Style BF10-13.0

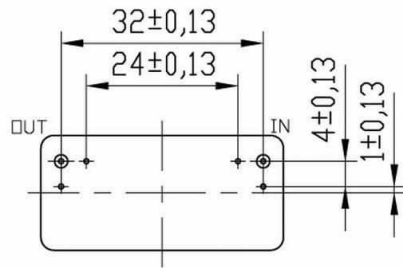

DIN IEC 49(C0)208
Typ F02

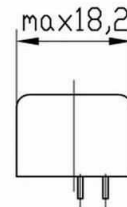
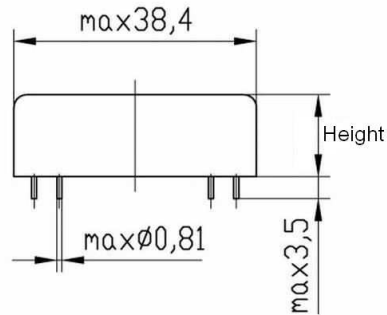

Height: BF10-13.0 = 13.0 mm

KVG Quartz Crystal Technology GMBH

D-74922 Neckarbischofsheim P.O.B. 61 74924 Neckarbischofsheim Waibstadter Strasse 2 - 4
Tel: +49 (0) 7263 / 648 - 0 Fax: +49 (0) 7263 / 6196 e-mail: info@kvg-gmbh.de