



ROHS-Compliant Product

Linear phase filter



Examples of our product range > 10.7 MHz ≤ 21.4 MHz

Type	Frequency	Case Style	Passband		Stopband		Termination in/out	POLE	Insertion loss max.
	MHz		dB	± kHz	dB	± kHz	(Ω)		dB
XF-108S02-LF	10,85	BF01	3	7,5	60	75	1000 // 25 pF	4	4
XF-110S01-LF	11,00	BF01	3	20	35	75	1000 // 25 pF	6	9
XF-110S02-LF	11,00	BF10-13.0	3	77,5	90	500	50	6	9
XF-175S02-LF	17,50	BF33	3	90	30	200	500	6	10
XF-175S03-LF	17,51515	BF33	3	126	35	300	50	6	12
XF-185S01-LF	18,50	BF41	3	37,5	6	64	50	6	8
XF-200S02-LF	20,00	BF10-13.0	3	14	60	25	1500 // 15 pF	10	3
XF-214S19-LF	21,40	BF01	3	5	60	40	400 // 15 pF	4	4
XF-214S89-LF	21,40	BF10-13.0	3	6	80	30	500 // 10 pF	8	4
XF-214S133-LF	21,40	BF10-13.0	3	6	80	30	50	8	4
XF-214S13-LF	21,40	BF01	3	8	60	80	300 // 25 pF	4	2,5
XF-214S134-LF	21,40	BF10-13.0	3	10	30	10	50	6	6
XF-214S61-LF	21,40	BF10-13.0	3	10	40	25	50	8	6
XF-214S120-LF	21,40	BF10-13.0	3	12,5	30	37,5	50	6	6
XF-214S115-LF	21,40	BF01	3	15	60	120	1200	4	4
XF-214S88-LF	21,40	BF10-13.0	3	15	60	120	50	6	6
XF-214S66-LF	21,40	BF10-13.0	6	21,31	26	31,93	330	8	3
XF-214S129-LF	21,40	BF10-13.0	3	50	60	175	50	6	6
XF-214S144-LF	21,40	BF10-13.0	3	60	60	300	50	6	9
XF-214S116-LF	21,40	BF10-13.0	3	190	60	1000	50	6	9

KVG Quartz Crystal Technology GMBH

D-74922 Neckarbischofsheim P.O.B. 61 74924 Neckarbischofsheim Waibstadter Strasse 2 - 4
 Tel: +49 (0) 7263 / 648 - 0 Fax: +49 (0) 7263 / 6196 e-mail: info@kvg-gmbh.de

Case Style BF01

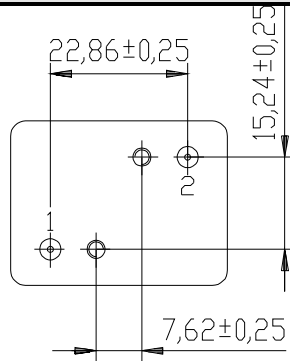

DIN IEC 49(CO)208
Typ F01

1 = IN
2 = OUT

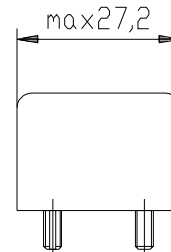
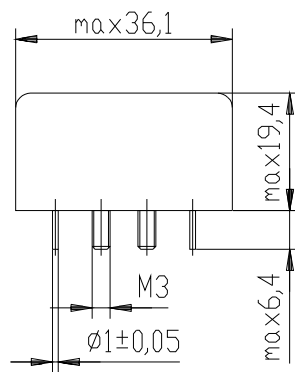

Case Style BF10-13.0

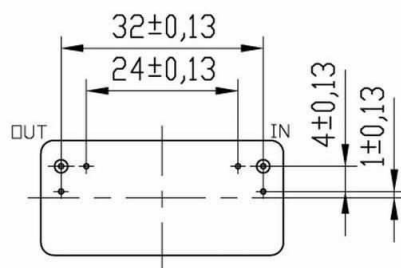

DIN IEC 49(CO)208
Typ F02

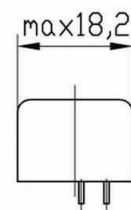
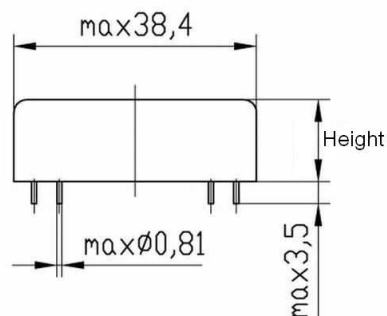

Height: BF10-13.0 = 13.0 mm



ROHS-Compliant Product

Linear phase filter



Case Style BF33

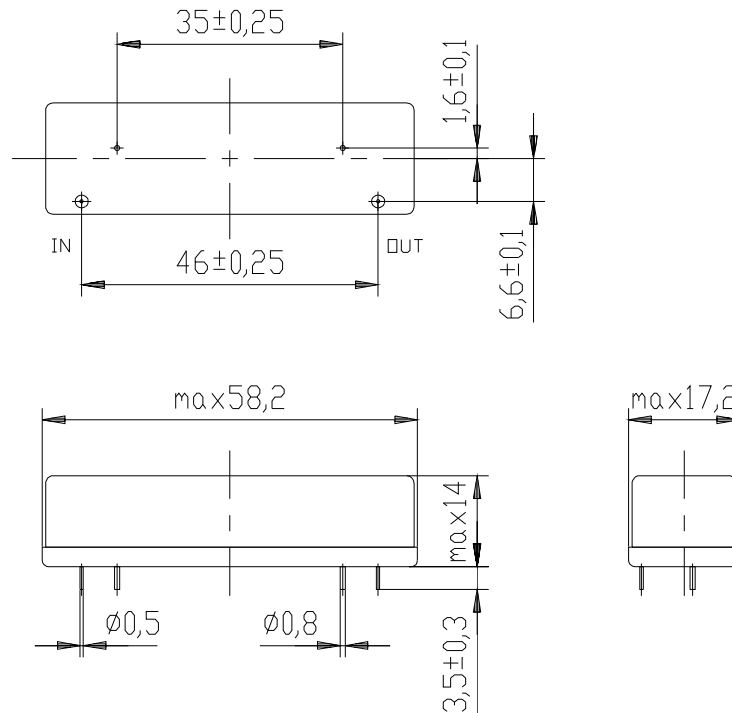

Case Style BF41

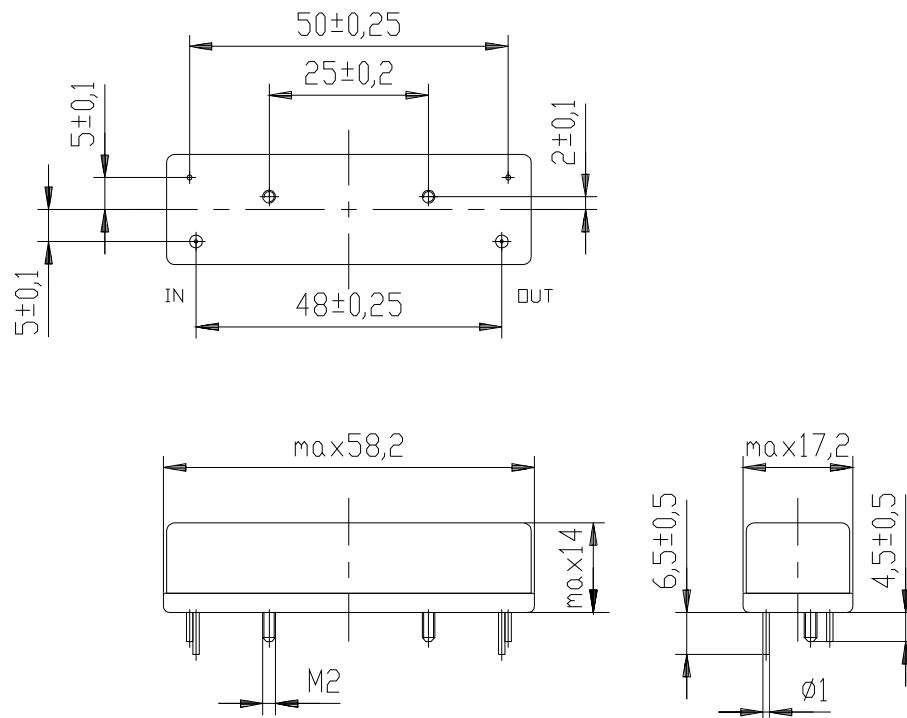

KVG Quartz Crystal Technology GMBH

D-74922 Neckarbischofsheim P.O.B. 61 74924 Neckarbischofsheim Waibstadter Strasse 2 - 4
Tel: +49 (0) 7263 / 648 - 0 Fax: +49 (0) 7263 / 6196 e-mail: info@kvg-gmbh.de