



ROHS-Compliant Product

Linear phase filter



Examples of our product range > 21.4 MHz

Type	Frequency	Case Style	Passband		Stopband		Termination in/out (Ω)	POLE	Insertion loss max. dB
	MHz		dB	± kHz	dB	± kHz			
XF-334S03-LF	33,40	BF10-13.0	3	50	20	240	3000 // 10 pF	4	6
XF-440S02-LF	44,00	BF10-13.0	3	50	60	500	50	4	6
XF-700S12-LF	70,00	BF10-13.0	3	5	60	100	50	4	6
XF-700S08-LF	70,00	BF10-13.0	3	15	60	300	50	4	7
XF-700S45-LF	70,00	BF10-10.0	3	20	40	90	50	4	9
XF-747S02-LF	74,70	BF10-13.0	6	4,5	60	50	50	4	6
XF-747S03-LF	74,70	BF10-13.0	3	7,5	60	20	50	8	8
XF-865S01-LF	86,5125	BF10-13.0	3	15	30	60	50	4	6
XF-1018S01-LF	101,80	BF10-13.0	3	12	25	100	50	2	6
XF-1248S03	124,80	BF199-13.5	3	35	60	300	50	4	6
XF-1248S04	124,80	BF199-13.5	3	20	60	300	50	4	7
XF-1248S05	124,80	BF199-13.5	3	30	60	300	50	4	6
XF-1248S06	124,80	BF06	3	30	60	300	50	4	6
XF-1248S07	124,80	BF199-13.5	3	35	60	300	50	4	4
XF-1248S08	124,80	BF06	3	35	60	300	50	4	4
XF-1248S02-LF	124,80	BF199-13.5	3	26	7	50	50	6	7

Case Style BF06

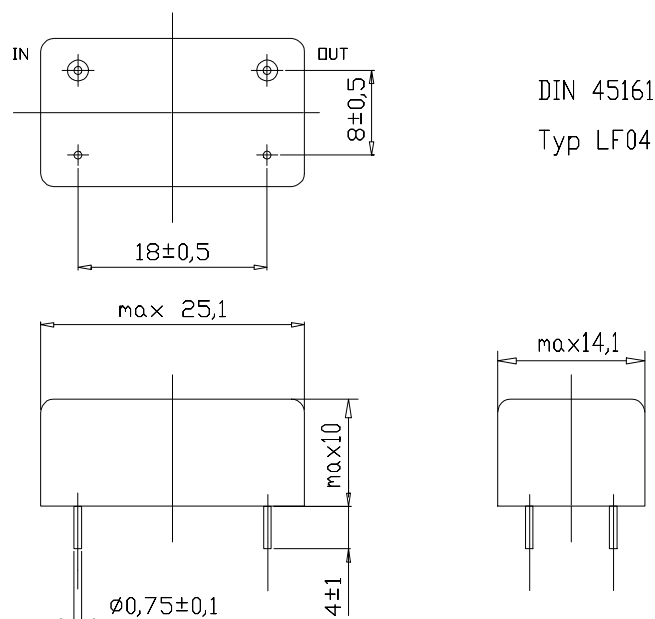

KVG Quartz Crystal Technology GMBH

D-74922 Neckarbischofsheim P.O.B. 61 74924 Neckarbischofsheim Waibstadter Strasse 2 - 4
Tel: +49 (0) 7263 / 648 - 0 Fax: +49 (0) 7263 / 6196 e-mail: info@kvg-gmbh.de



ROHS-Compliant Product

Linear phase filter



Case Style BF10-10.0; BF10-13.0

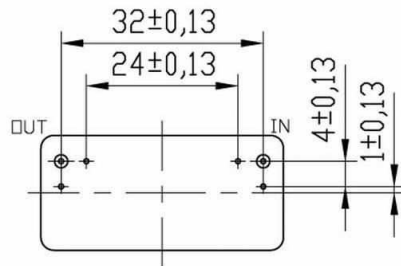

DIN IEC 49(CO)208

Typ F02

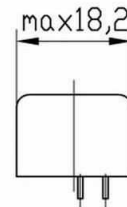
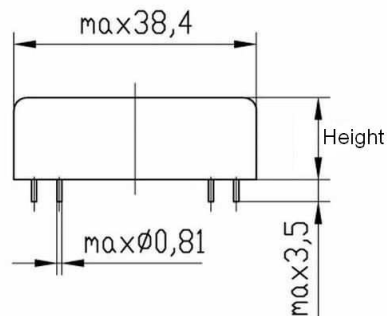

Height: BF10-10.0 = 10.0 mm
BF10-13.0 = 13.0 mm

Case Style BF199-13.5

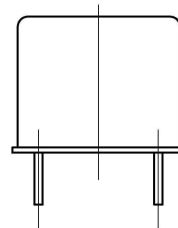
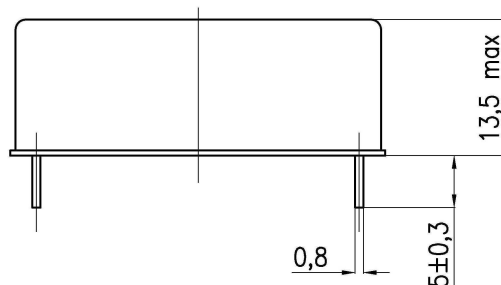
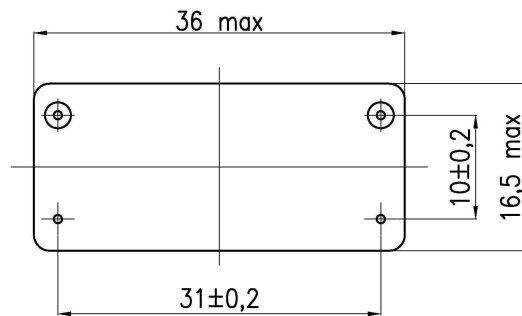

KVG Quartz Crystal Technology GMBH

D-74922 Neckarbischofsheim P.O.B. 61 74924 Neckarbischofsheim Waibstadter Strasse 2 - 4
Tel: +49 (0) 7263 / 648 - 0 Fax: +49 (0) 7263 / 6196 e-mail: info@kvg-gmbh.de