



# XO-9500/9600 Series

1. Specification		
Type:	<b>XO-9500</b> +5V ± 5%	<b>XO-9600</b> +3.3V ± 5%
Nom. freq. Range :	1 ... 66.0 MHz	
Frequency stability Options: +50ppm : ±100ppm :	<b>XO-9510</b> <b>XO-9520</b>	<b>XO-9610</b> <b>XO-9620</b>
Frequency stability is considered as the overall stability including temp.stability, nom.frequency tolerance at 25°C, +/-5% changes vs. load and supply voltage, 1 <sup>st</sup> year aging.		
Temp.range Options -20°C to +70°C : -40°C to +85°C :	<b>S</b> <b>E</b>	
TriState Options :	<b>F:</b> Fixed Frequency without Tri-State <b>T:</b> Tri-State function	
TriState Function :	N.C.: Enable Logic High: Enable Logic Low: Disable / High Impedance	
Current consumption:	≤ 40 mA	
Output voltage : level : load : duty cycle :	HCMOS/TTL low < 10% V <sub>S</sub> , high > 90% V <sub>S</sub> 1kOhm // 15pF...50pF 45% ... 55 %	
2. Environmental conditions		
According to KVG Product Qualification Procedure AA-QM-202		
3. Marking		
KVG, date code(week/year); Specification; Center frequency		

4				<b>KVG Quartz Crystal Technology GmbH</b> <b>P.O.Box 61</b> <b>D-74924 Neckarbischofsheim</b> Tel. +49 (0) 7263 / 648-0 Fax. +49 (0) 7263 / 6196
3	T&R + Reflow profile added	30.01.19	W.Balzer	
2	Output voltage level added	22.04.09	M. Zupan	
1		07.06.02	M. Zupan	
ED	Description	Date	Name	



# XO-9500/9600 Series

## 4. Case

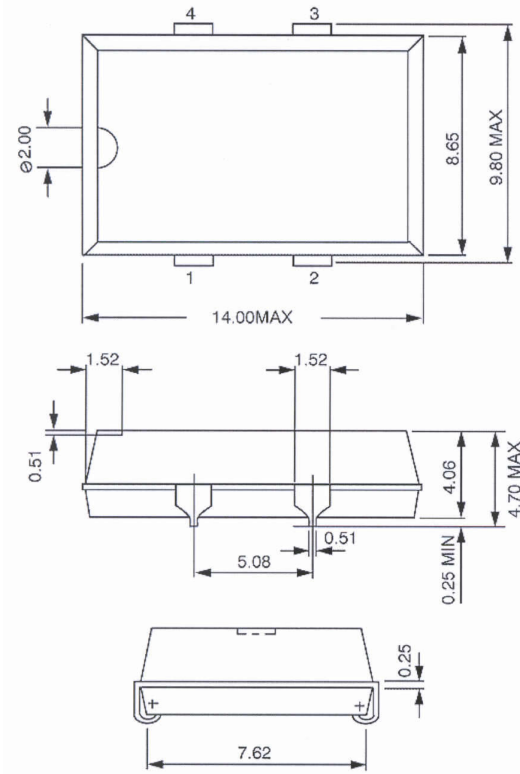

• Recommended Soldering Pattern

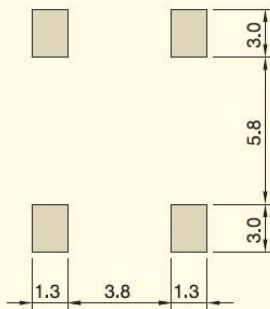

### 1.Pin configuration

1. N. C. or TriState
2. Ground
3. RF-output
4. Supply voltage

4				<b>KVG Quartz Crystal Technology GmbH</b> <b>P.O.Box 61</b> <b>D-74924 Neckarbischofsheim</b> Tel. +49 (0) 7263 / 648-0 Fax. +49 (0) 7263 / 6196
3	T&R + Reflow profile added	30.01.19	W.Balzer	
2	Ouput voltage level added	22.04.09	M. Zupan	
1		07.06.02	M. Zupan	
ED	Description	Date	Name	



ROHS-Compliant Product

# XO-9500/9600 Series

## 5. Tape & Reel

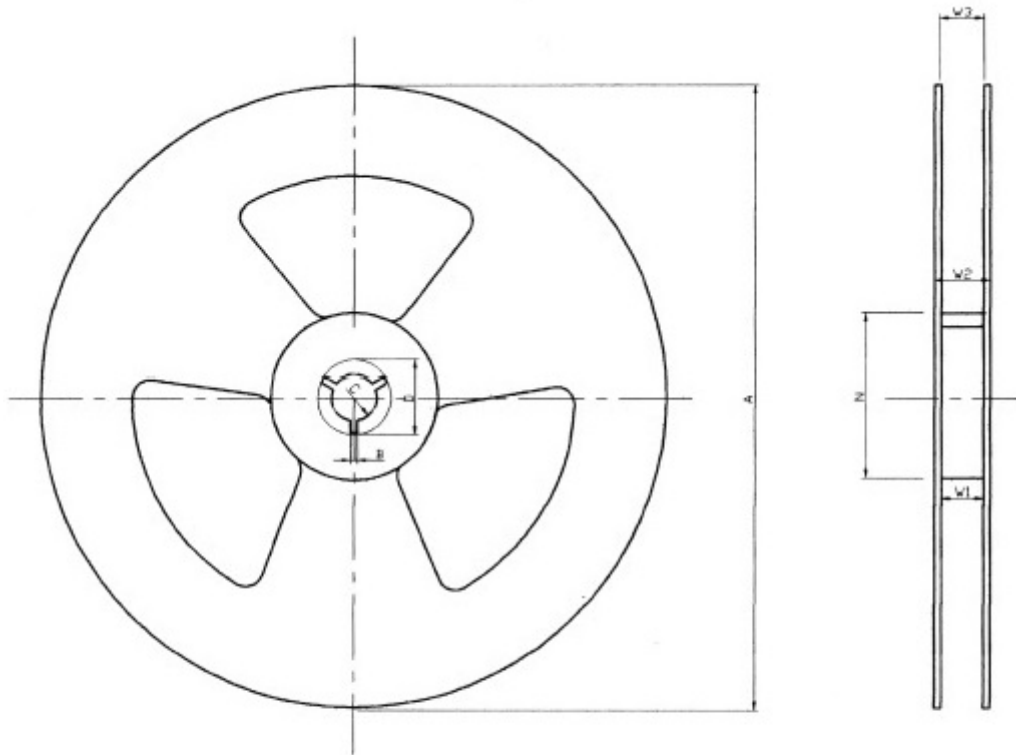

	A	B	C	D	N	W1	W2	W3
8mm	178mm	2.4 <sup>+0.1</sup>	13 <sup>+0.2</sup>	20.2	50	8.4 <sup>+1.5</sup> -0.0	14.4	7.9/10.9
12mm						12.4 <sup>+2.0</sup> -0.0	18.4	11.9/15.9
16mm						16.4 <sup>+2.0</sup> -0.0	22.4	15.9/19.4
24mm	330mm	2.4 <sup>+0.1</sup>	13 <sup>+0.2</sup>	20.2	100	24.4 <sup>+2.0</sup> -0.0	30.4	23.9/27.4
32mm						32.4 <sup>+2.0</sup> -0.0	38.4	31.9/35.4
44mm						44.4 <sup>+2.0</sup> -0.0	50.4	43.9/47.4
56mm						56.4 <sup>+2.0</sup> -0.0	62.4	55.9/59.4

4				<b>KVG Quartz Crystal Technology GmbH</b> <b>P.O.Box 61</b> <b>D-74924 Neckarbischofsheim</b> Tel. +49 (0) 7263 / 648-0 Fax. +49 (0) 7263 / 6196
3	T&R + Reflow profile added	30.01.19	W.Balzer	
2	Output voltage level added	22.04.09	M. Zupan	
1		07.06.02	M. Zupan	
ED	Description	Date	Name	



ROHS-Compliant Product

# XO-9500/9600 Series

Symbol	Spec	Symbol	Spec
W	24,00±0,3	A <sub>0</sub>	9,70±0,1
E	1,75±0,1	B <sub>0</sub>	14,10±0,1
F	11,50±0,1	B <sub>1</sub>	7,60±0,1
D <sub>0</sub>	1,50 <sup>+0,1</sup> <sub>-0,0</sub>	K <sub>0</sub>	5,70±0,1
P <sub>0</sub>	4,00±0,1	K <sub>1</sub>	4,70±0,1
P <sub>1</sub>	12,00±0,1	D <sub>1</sub>	1,50 <sup>+0,1</sup> <sub>-0,0</sub>
P <sub>2</sub>	2,00±0,1		
t	0,40±0,05		

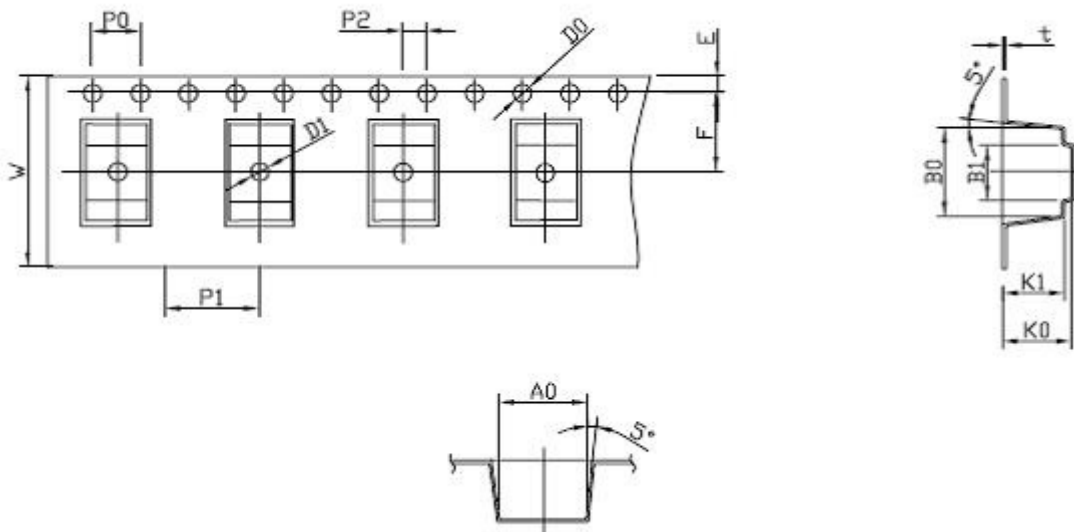

4				<b>KVG Quartz Crystal Technology GmbH</b> <b>P.O.Box 61</b> <b>D-74924 Neckarbischofsheim</b> Tel. +49 (0) 7263 / 648-0 Fax. +49 (0) 7263 / 6196
3	T&R + Reflow profile added	30.01.19	W.Balzer	
2	Output voltage level added	22.04.09	M. Zupan	
1		07.06.02	M. Zupan	
ED	Description	Date	Name	



# XO-9500/9600 Series

## 6. Reflow Soldering Profile

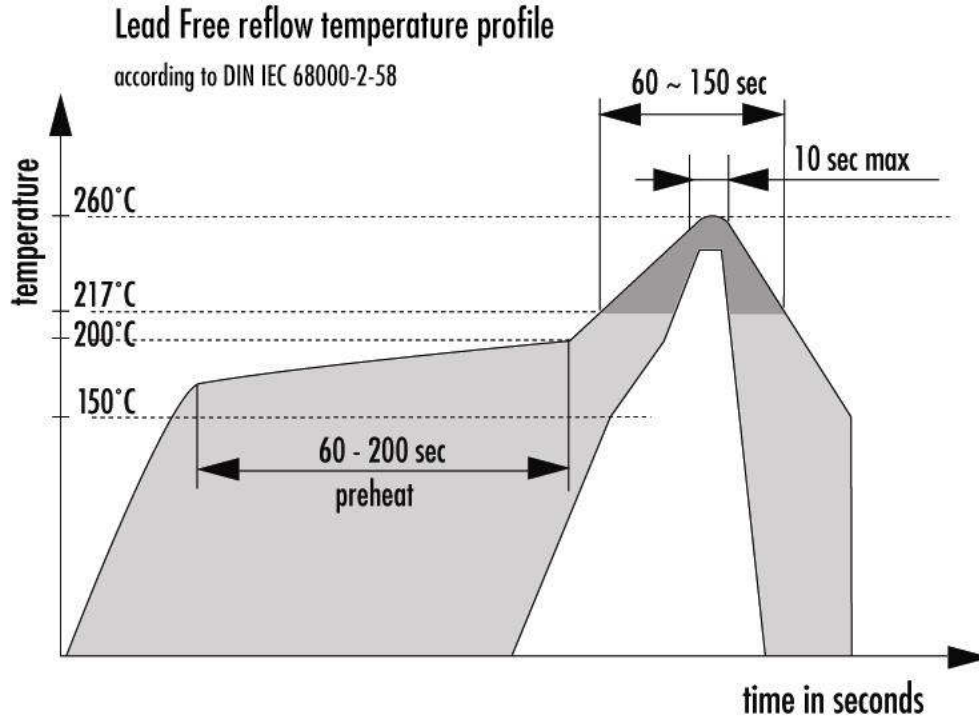

4				<b>KVG Quartz Crystal Technology GmbH</b> <b>P.O.Box 61</b> <b>D-74924 Neckarbischofsheim</b> Tel. +49 (0) 7263 / 648-0 Fax. +49 (0) 7263 / 6196
3	T&R + Reflow profile added	30.01.19	W.Balzer	
2	Ouput voltage level added	22.04.09	M. Zupan	
1		07.06.02	M. Zupan	
ED	Description	Date	Name	